

# 10-TM-2000

Max. 2000 kg - 16 mm - 4Hz



TM-Mountings are widely used for the suspension of rotating equipment like generator-sets, pump-units and cooling-machinery. These mountings are designed for loads from 3 kN to 20 kN and have natural frequencies of less than 4 Hz. The mountings have high deflection capabilities which gives 97% insulation against 1500 r.p.m. TM-Mountings have a long service life and can withstand shocks of 3 to 5 g without damage.

Applications: total-energy-units, diesel-generatorsets, pumpunits, cooling equipment, compressor-units etc.

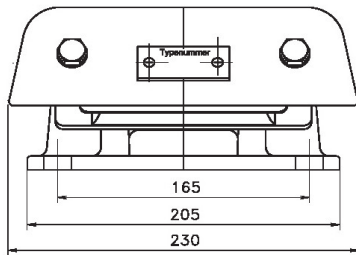

**Typenr. 10-TM-2000-H**

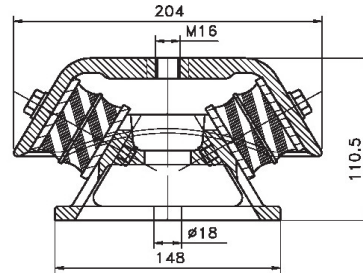

**Typenr. 10-TM-2000-N**

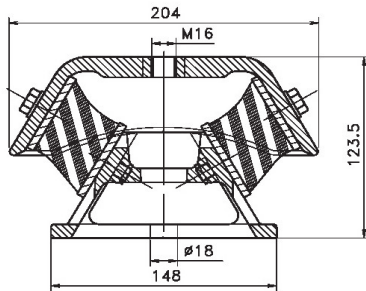

**Typenr. 10-TM-2000-H**

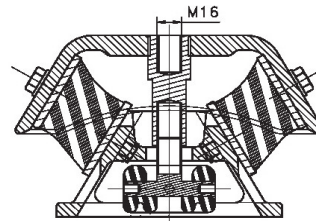

**Typenr. 10-TM-2000-T**

### LOAD CHARACTERISTICS 10-TM-2000-H

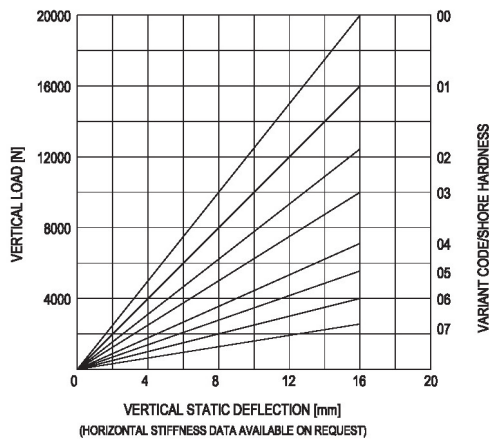

### LOAD CHARACTERISTICS 10-TM-2000-N

